

## Hofmann Automatic Tire Grading Lines

Quality grading of uniformity, geometry and balancing of passenger car tires or SUV tires together in one line:

### Automatic Tire Grading Line Type ATG-E/D-eco



### Automatic Tire Grading Line Type ATG-E/D

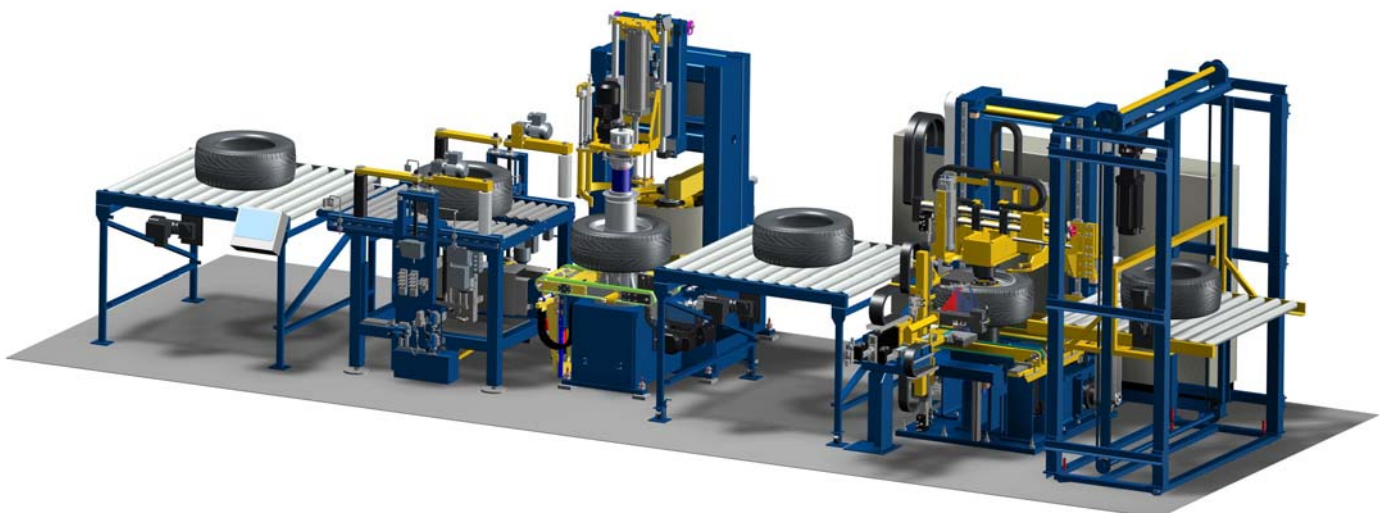

## Automatic Tire Grading Lines

Technical Data		ATG-E/D-eco	ATG-E/D
<b>Tire Dimensions</b>			
nominal tire diameter range (size A)	inch	13-24	12-23
max. tire outer diameter (size C)	mm	900	900
min. tire outer diameter (size C)	mm	540	500
max. tire width (size C)	mm	400	400
without geometry measuring			
min. tire width (size C)	mm	130	125
tire weight max.	kg	50	50
<b>Machine data</b>			
rim width adjustment	inch	8(RGM) 5(ARS)	8(RGM) 5(ARS)
adjustment step	inch	0,5	0,5
balancing speed, approx.	rpm	400-600	400-600
tire setting pressure, max.	bar	5,0	4,2
tire inflation pressure	bar	1,5-4	1,5-4
accuracy of inflation pressure	mbar	≤ 100	± 100
<b>Cycle time</b>			
one entire automatic balancing cycle (with indexing, without marking, incl. max 1,5" rim width adjustment)	sec	≤ 21,5 ± 10 %	≤ 21,5 ± 10 %
<b>Electric</b>			
connecting power	kVA	35	35
<b>Environment</b>			
ambient temperature	°C	5-40	5-40
max. relative humidity at 20°C	%	90	90
max. relative humidity at 40°C	%	50	50
<b>Pneumatic unit</b>			
main air pressure supply (provided by customer)	bar	6	6
air consumption, approx.	Nm³/h	280	280
max. noise control (according to EN ISO)	dBA	≤ 75	< 75
		single piece mode	batch mode

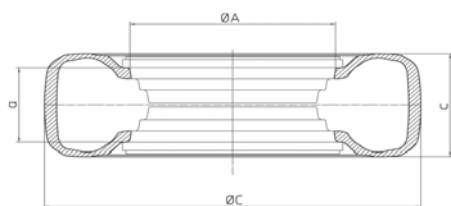

ØA = tire nominal diameter  
 a = interpolator space = rim width  
 ØC = tire working outer-diameter  
 c = tire working width

# HOFMANN

Hofmann Maschinen- und Anlagenbau GmbH

Altrheinstraße 11  
67550 Worms

Germany

Tel.: +49 6242 904-0 / Fax: +49 6242 904-286

E-Mail: [tiretesting@hofmannmaschinen.com](mailto:tiretesting@hofmannmaschinen.com)

[www.hofmannmaschinen.com](http://www.hofmannmaschinen.com)

*Please contact us for further information.*

